

Data Sheet

APM dew point transmitter -100 to +20 ° C Dp | 0.01ppm - 23,000ppmv

2-wire loop-operated robust dew point transmitter for continuous measurement of the moisture content of compressed air or process gas.



Main features of SmartDPT

- ◇ Dew point range from -100 ° C to + 20 ° C
- ◇ Measuring range 0.01 to 23,000 ppm (V)
- ◇ 2-wire
- ◇ 8 to 36 V DC operation
- ◇ Linear 4-20 mA signal
- ◇ Degree of protection IP65
- ◇ Fast reaction time
- ◇ Long-term stability of the calibration
- ◇ Traceable to national standards

Data Sheet

SmartDPT dew point transmitter -100 to +20 ° C Dp | 0.01ppm - 23,000ppmv

2-wire loop-operated robust dew point transmitter for continuous measurement of the moisture content of compressed air or process gas.

An advanced dew point transmitter

The SmartDPT makes monitoring dew points as easy as measuring temperature or pressure and can be immediately integrated into air or gas measurement and control systems. The highly automated manufacturing, calibration and test processes make the SmartDPT not only a very robust and reliable, but also a very inexpensive measuring instrument. By using our replacement sensor program, users can be sure that their process moisture measurement system will never be interrupted.

TECHNICAL SPECIFICATIONS APM Dewpoint Transmitter	
Measuring range (dew point)	-100 to + 20 ° C dew point (-148 to + 68 ° F)
Accuracy (dew point)	± 2 ° C dew point (± 3.6 ° F)
Reaction time	1 min to T95 (dry to wet)
Repeatability	0.5 ° C dew point (0.9 ° F)
Calibration	Traceable 7-point calibration certificate
ELECTRIC INPUT / OUTPUT	
Output signal	4-20 mA current source, configurable over the entire dew point range
	-100 to + 20 ° C / -148 to + 68 ° F / 0.01-23,000 ppm (v)
	ppm (v) output or non-standard dew point range can be specified at time of order
Supply voltage	8 - 36 VDC
Load resistance	Max 660 Ω at 24 V 160 Ω at 12 V.
Current consumption	23mA max
CE marked	
OPERATING CONDITIONS	
Operating temperatur	-40 to + 60 ° C (-40 to + 140 ° F)
Operating humidity	0-100% RH
Operating pressure	400bar / 40 MPa max
Flow rate	0.2 to 5 l / min mounted in a standard sampling block
	0 to 10 ms-1 direct insertion
Temperature coefficient	Temperature compensated (within the permissible operating temperature range)

MECHANICAL SPECIFICATIONS		
Ingress Protection Sensor	IP65	
Housing Material	Stainless steel	
Dimensions	114mm x 30mm (diameter)	
Weight	0.2 to 5 l / min mounted in a standard sampling block	
	170g	
Filter	5µm sintered filter	
Interchangeability	Fully interchangeable without need to set or calibrate on site	
Fault Conditions (factory programmed)	Condition	Output
	Sensor fault	23 mA (or 3.5mA, programmable)
	Under-range dew point	4 mA
	Over-range dew point	20 mA

Dimensional drawing

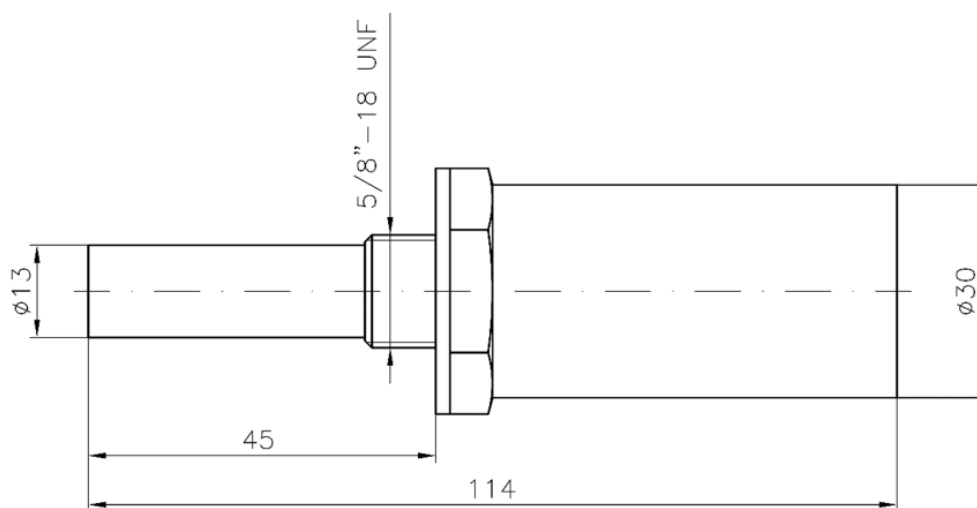

ACCESORIES

APM Com Interface

The SmartDPT transmitter is factory configured. The Com interface is employed in cases, where the user wishes to configure the SmartDPT transmitter in his own plant. (Dimensions 35x20x60)



APM Sensor Block

Employed where the user wishes to install the transmitter off-line. Fittings extra according to customer requirement.

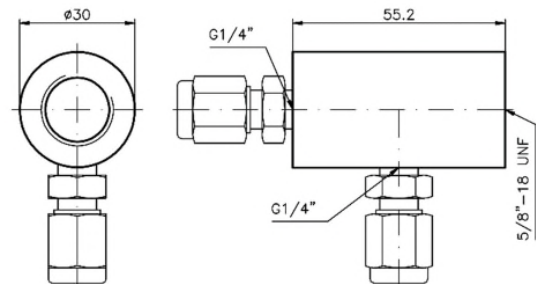

APM Interface

The DEWCom transmitter is factory configured. The DEWCom interface is employed in cases, where the user wishes to configure the DEWCom transmitter in his own plant. (Dimensions 35x20x60)



We are here for you. Addresses and Contacts.

Headquarter Switzerland:

Angst+Pfister Sensors and Power AG
Thurgauerstrasse 66
CH-8050 Zurich
Phone +41 44 877 35 00
sensorsandpower@angst-pfister.com

Office Germany:

Angst+Pfister Sensors and Power Deutschland GmbH
Edisonstraße 16
D-85716 Unterschleißheim
Phone +49 89 374 288 87 00
sensorsandpower.de@angst-pfister.com

Scan here and get an overview of personal contacts!



sensorsandpower.angst-pfister.com
