

DATASHEET

SPD100AAhybSM Pressure Sensor

last update
October 5, 2016

reference
spd100aahybsm n

page
1/1

SPECIAL 100 PSI PRESSURE RANGE ABSOLUTE SENSOR WITH ANALOGUE OUTPUT

This Smartec absolute pressure sensor has an amplified analogue output. The sensor is compensated for offset, sensitivity, temperature drift and nonlinearity. The sensor has a range of 100 PSI FS and the output is ratiometric to the power supply voltage. Other pressure ranges on request (0.3 – 100 PSI). The pin out is compatible to the analogue version of the SMI5812 series.

Electrical Characteristics

Performance Characteristic at Vcc =5V excitation @ 25 °C

Parameter	Min	Typ	Max	Units.
Supply Voltage	4.75	5.00	5.25	V
Supply Current	-	2.5		mA
Pressure range (fs)	0		100	PSI
Zero Output (0 PSI)	0.42	0.50	0.58	Vdc
Span Output (Dif)		4.00		Vdc
Response time		1	2	ms
Linearity	-0.5		+0.5	%FS
Thermal Hysteresis	-0.15		+0.15	%FS
Pressure overload			3X	rating
Temp compensation	0		70	°C
Operating Temp range	-40		125	°C
Storage temperature	-40		125	°C

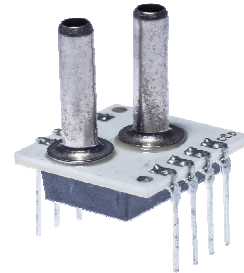

Wetted materials are: Pyrex glass, RTV, Ceramic, Nickel and Silicon

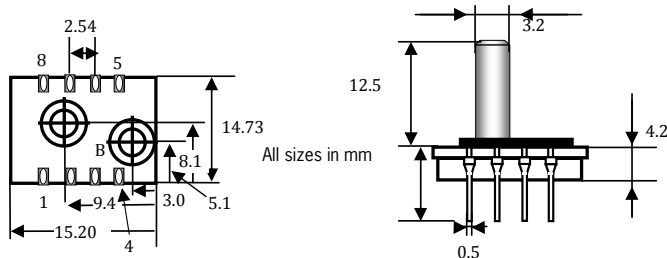

Use of N.C. pins will cause malfunction
Connect between Vss and Vdd a capacitor of 100 nF

		Pinout	
1	NC	5	NC
2	GND	6	NC
3	NC	7	Vcc
4	NC	8	A out



We are here for you. Addresses and Contacts.

Headquarter Switzerland:

Angst+Pfister Sensors and Power AG
Thurgauerstrasse 66
CH-8050 Zurich
Phone +41 44 877 35 00
sensorsandpower@angst-pfister.com

Office Germany:

Angst+Pfister Sensors and Power Deutschland GmbH
Edisonstraße 16
D-85716 Unterschleißheim
Phone +49 89 374 288 87 00
sensorsandpower.de@angst-pfister.com

Scan here and get an overview of personal contacts!



sensorsandpower.angst-pfister.com
